

BARTLETT® 95

95 mm Trailer Ball Coupling Medium Application Trailers

Ratings

Rigid Drawbar (Pig) Trailer

Max. ATM 7 000 kg
Static Vertical Load by Formula -
See information sheet "95 Ratings Explained"

Hinged Drawbar Dog Trailer

D-Value 70 kN

Use the Bartlett 95 to tow valuable trailer loads such as wood chippers, earthmoving machinery, coach camping trailers, general cargo and many others.

Features include:

- **Low profile ball and socket design** to maximise strength and minimise stress.
- **22.5° Oscillation** - Fore, aft and twist ~ Most coupling designs are restricted to less.

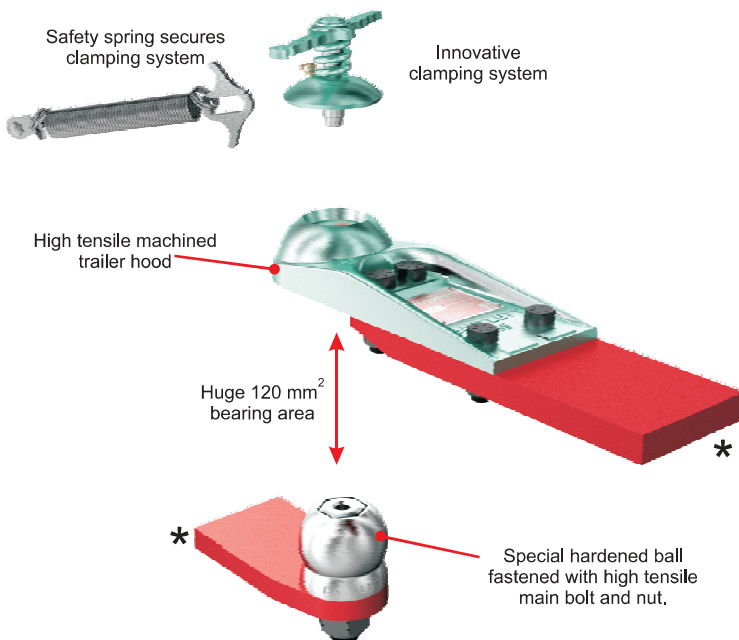

* Mounting lugs not included
Shown for illustration only.
Optional Extras - See Bartlett

How it works

1. Lower trailer hood onto ball
2. Clamp trailer to ball using clamping assembly
3. Secure clamping system with safety spring
4. Connect supply lines - start towing



- **Massive spherical bearing area** for extended coupling life ~ minimal maintenance means value for money.
- **Micro working clearances** - eliminate the fatigue and backlash inherent in all ring couplings. Zero backlash means protection for cargo, geartrain, driveline, driver and passengers. Truck and trailer are united as one vehicle.
- **ADR 62 testing and compliance** - for legal security.

• Look no further than the genuine Bartlett 95.

Bartlett also manufactures a range of towbar kits and safety chain systems for complete towing surety.

DISTRIBUTOR

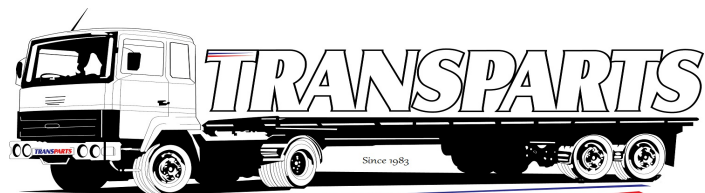

Always specify genuine Bartlett equipment .

BARTLETT® 95 BALL

95 mm Trailer Ball Coupling Parts

Ratings:

Rigid Drawbar Pig Trailer Max. ATM 7 000 kg, SVL by formula

Hinged Drawbar Dog Trailer D-Value 70 kN

375DX Truck (Ball) Kit

Item	Part No.	Description
b	375/2	Ball - Hardened Cast Iron
c	375/3	Cap
d	375/4	Main Bolt - Grade 8
e	5-3/5	Nyloc Nut - Grade 8 & Washer
f	375/6	Clamping Bolt - High Tensile
g	375/7	Compression Spring
h	5-3/9	Safety Spring

375AX Trailer Kit

Item	Part No.	Description
a	375/1	Trailer Hood - Alloy Steel
i	375/10	Mounting Bolt - Pair Grade 8
j	375/11	Mounting Bolt - Pair Grade 8

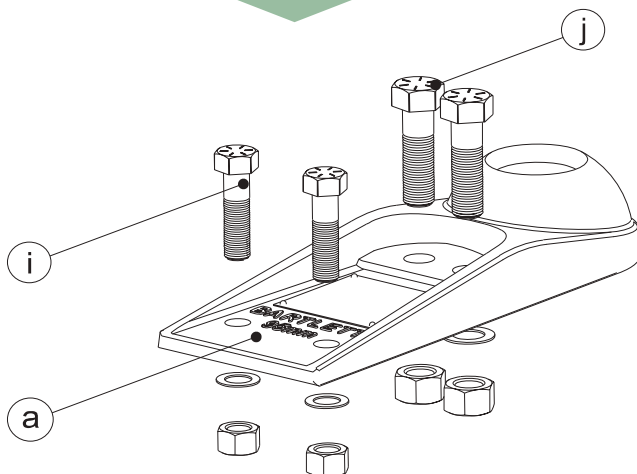

Shipping Mass 6 kg

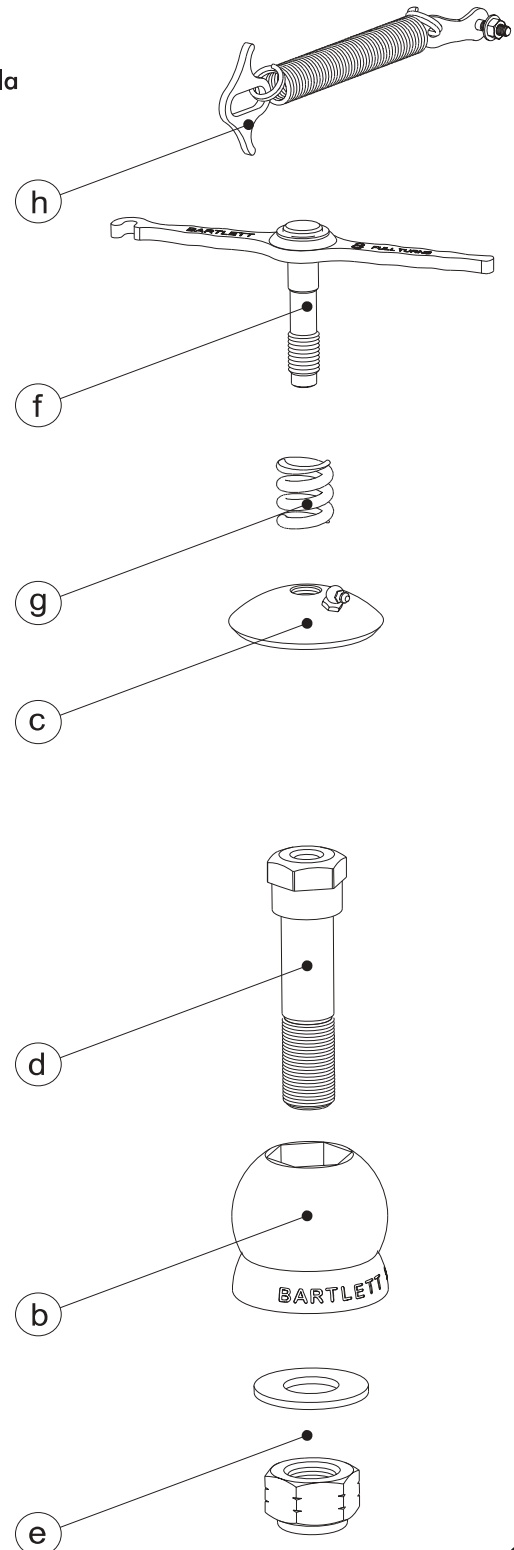

Shipping Mass 7 kg

Towbars, mounting lugs and other accessories also available

*Bartlett reserves the right to alter specifications without notice.

© Bartlett ® 2007

Bartlett® 95

95 mm Trailer Ball Coupling Dimensions

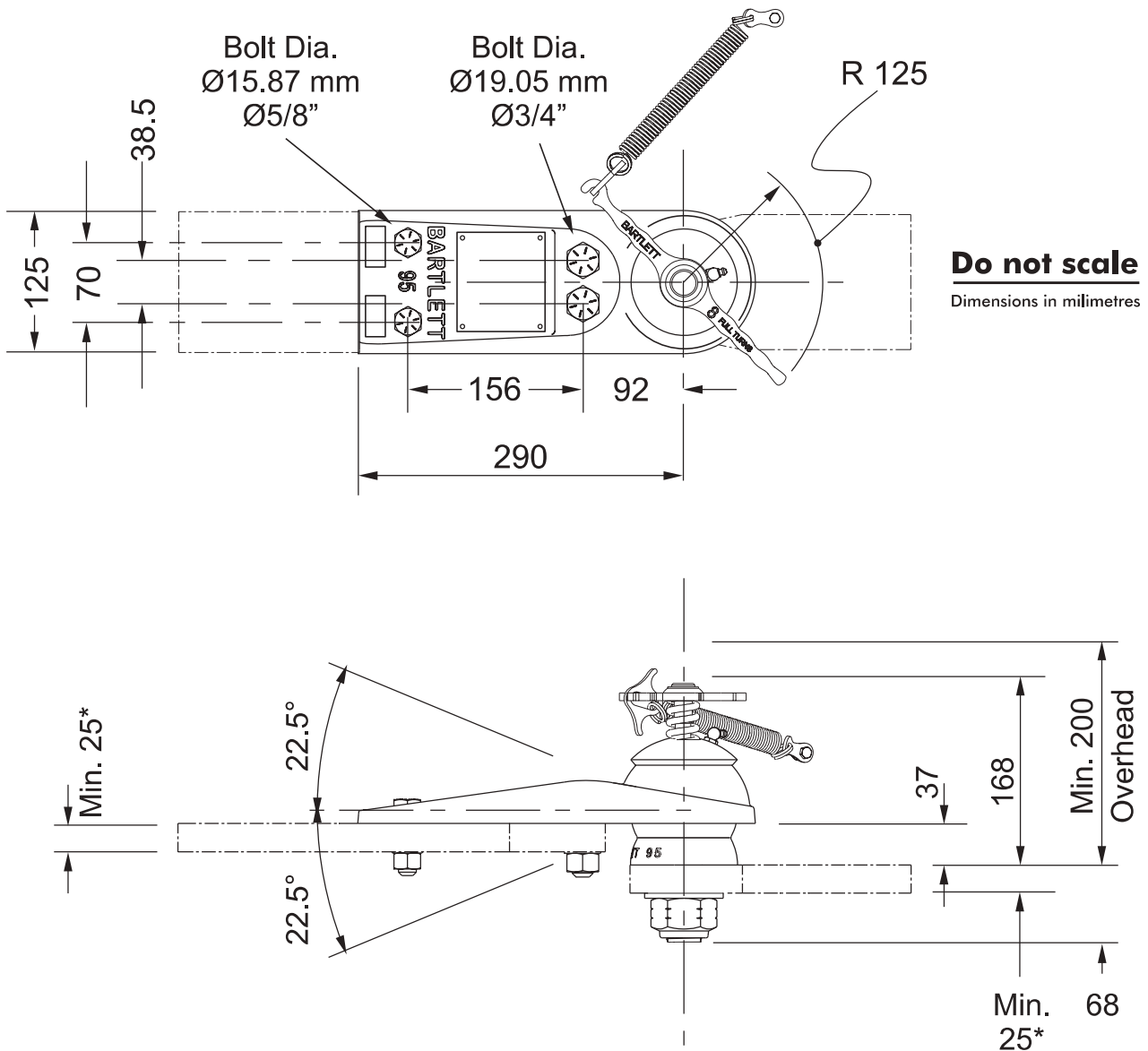

- Mounting lugs not included, shown for illustration purpose only - Available at extra cost.
- Mounting lugs must be adequately supported as dictated by professional design engineer.
- DWG or DXF file available on approval
- Complete towbar kits also available - bartlett-equip.com.au
- Bartlett Reserves the right to alter specifications without notice