

BT1400A

Suits Automatic Pin Couplings
Standard 21 500 kg ATM - Upgradeable to 30 000 kg

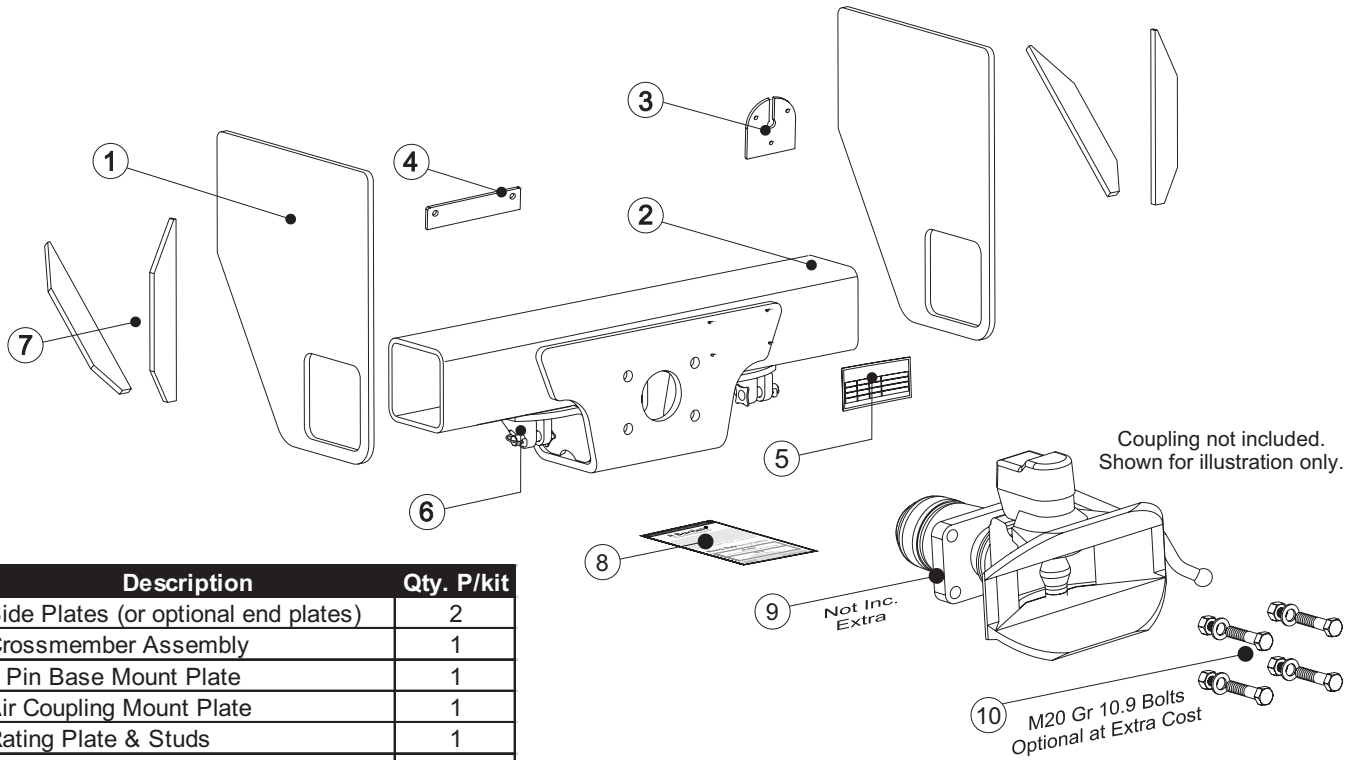

Item	Description	Qty. P/kit
1	Side Plates (or optional end plates)	2
2	Crossmember Assembly	1
3	7 Pin Base Mount Plate	1
4	Air Coupling Mount Plate	1
5	Rating Plate & Studs	1
6	16 mm Safety Chain Attachments	2
7	Sideplate Lateral Braces	4
8	Detailed instruction booklet	1
9	Trailer Coupling - Not Included, Extra	Nil
10	Mounting Bolt set M20 Grade 10.9	Nil

Ratings:
 Standard 21 500kg A.T.M
 Upgradeable to maximum ATM's
Shipping Mass Inc. Pallet = 110 Kg.

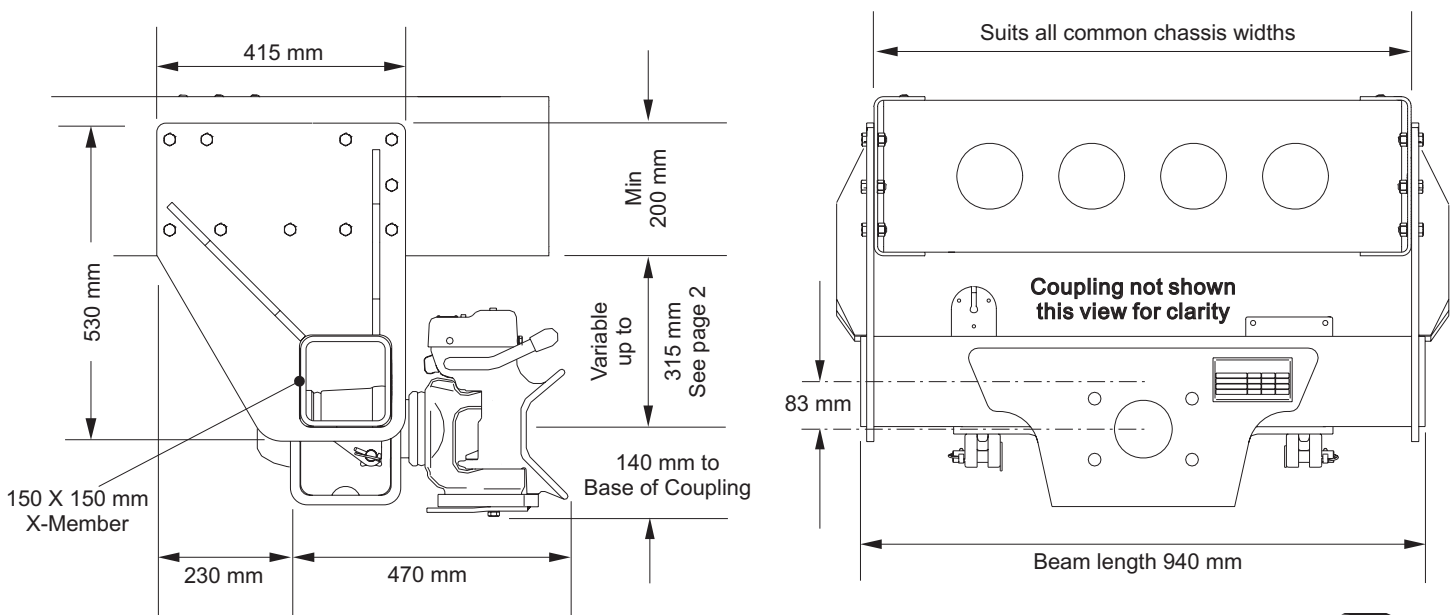

* Coupling depicted Typical 50 mm Ringfeder®
 * Coupling, sideplate mounting holes and all bolts shown for illustration only - not included
 **BTI reserves the right to alter specifications without notice.

BT1400A

Versatile Mounting Orientations
Achieve a wide range of coupling heights with ease.

Standard

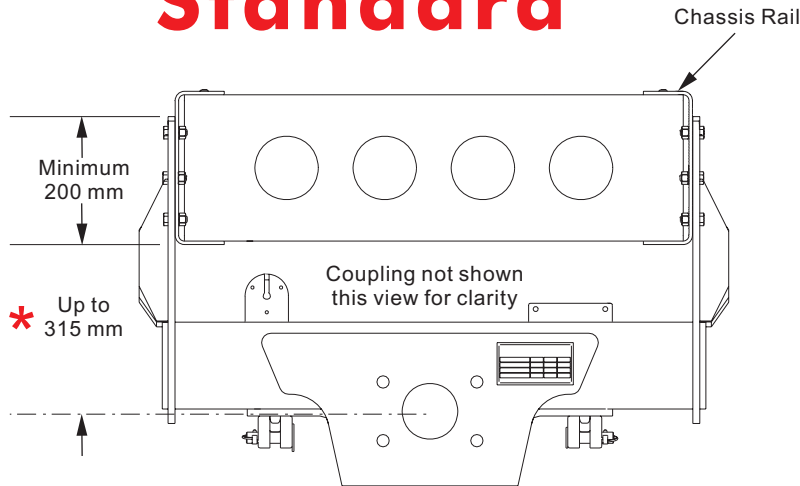

The Standard mounting orientation for the Bartlett BT1400A towbar is slung under the chassis through sideplates externally bolted. This is ideal for vehicles with sufficient rear overhang such as tautliners, tray bodies and some tippers. See the Bartlett BT1700A towbar where rear axle or suspension components may foul the BT1400A crossmember.

Inverted

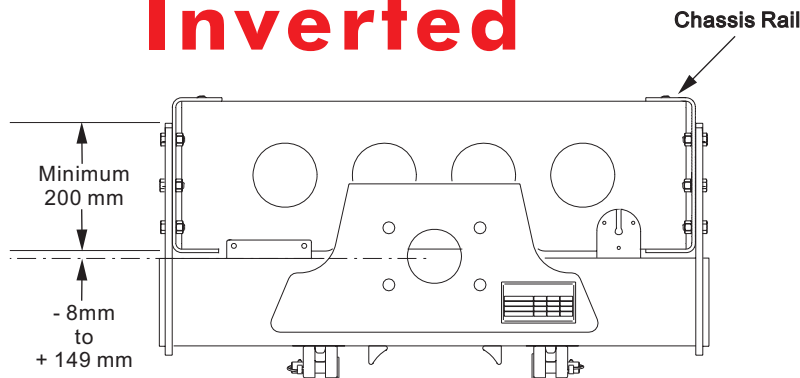

Invert the Bartlett BT1400A towbar to achieve the highest possible centre of coupling height using the standard (shortened) sideplates. **Special Build** - This option needs to be specified so that the safety chain attachment positions and rating plate hole positions can be adjusted from standard.

Mid Chassis

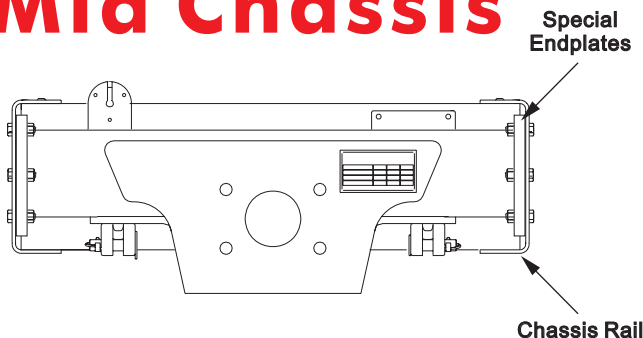

Mount the BT1400A cross member between the inside webs of the chassis rails for high trailer drawbars. **Special Build** - This option needs to be specified when ordering.

*** Customisation of Sideplate
Shape is Possible**